

REMOVED COVER FOR CLARITY

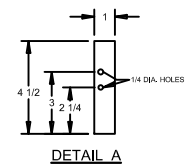

- SHELL .187 NOM SA414 GR G P.V.Q. DES. THK .094 E= 70% HEADS.187 MIN SA414 GR G P.V.Q. DES. THK .094 S= 85%
- WORKING PRESSURE 150 PSI
- TEST PRESSURE HYDRO 195 PSI
- TEMPERATURE MIN. -20°F MAX 400°F
- ALL WELDED FITTINGS MUST BE HELD PERPENDICULAR TO CENTERLINE WITHIN 3/8" IN 12"
- IMPACT TEST EXEMPT PER PAR-UG-20(F)
- SPECIFICATIONS:
CALCULATED WEIGHT: 654 LB
CALCULATED CAPACITY: 60 GALLONS
- CRN- NONE
- N.D.T.- PT - SEE INSPECTION NOTE
- FINISH- SEE 139-656 FINISH SPEC

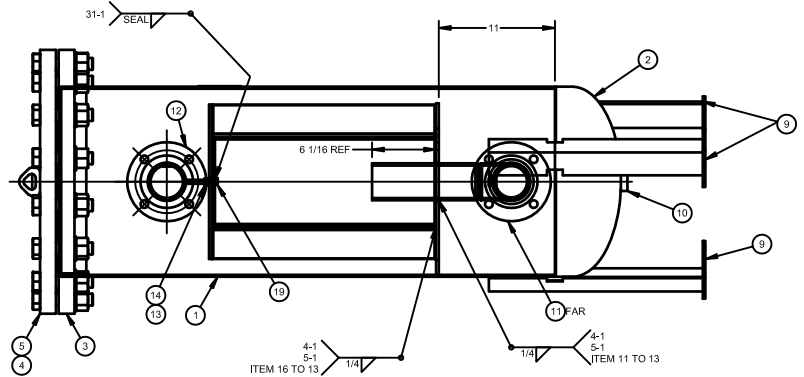
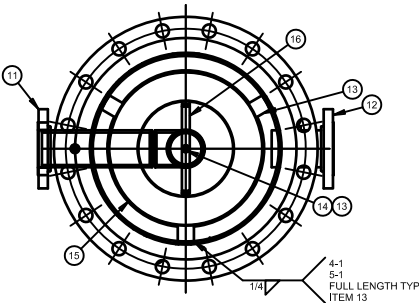
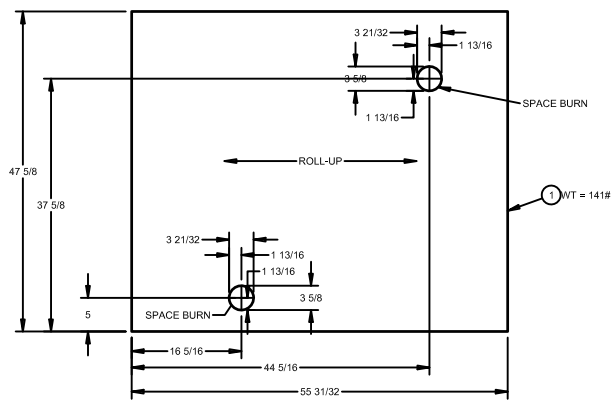

ITEM	QTY	DESCRIPTION
18	2	CPLG 1/4 NPT 3000#
17	1	DPG GAUGE MOUNT
16	1	DATA PLATE ASME SST
15	2	LIFTING LUG PHOENIX 2-898-MINI
14	2	NUT 3/8-16 UNC HEX ZINC PLTD
13	2	WASHER FLAT 3/8 ZINC PLTD
12	1	FLG 3.000 150# RFSO & PIPE S40 0.216W ASSY
11	1	FLG 3.000 150# RFSO, ELBOW & PIPE S40 0.216W ASSY
9	3	LEG ASSY
10	1	FLG PILOT 1 NPT SA181-70
8	16	NUT 1 1/8-7 UNC HEX ZINC PLTD
7	16	WASHER FLAT 1 1/8 ZINC PLTD
6	16	BOLT 1 1/8-7 UNC HEX X 5 ZINC PLTD
5	1	COVER ASSY
4	1	GASKET RING 18 150# NEOPRENE
3	1	FLG 18 150# RFSO SA105
2	1	HEAD - ELL 18 DIA 910-308
1	1	SHELL 0.187 X 47.83 X 55.86

(BUILT IN ACCORDANCE WITH LATEST EDITION OF SECTION VIII DIV 1 ASME CODE)
THIS DRAWING & SPECIFICATIONS ARE PROPERTY OF nano-purification solutions AND MAY NOT BE COPIED, REPRODUCED, OR USED IN WHOLE OR PART, AS A BASIS FOR DESIGN MANUFACTURE OR SALE WITHOUT PRIOR PERMISSION FROM nano-purification solutions.

REV	DESCRIPTION	BY	DATE
C	UPDATED BOM/DIMENSIONS	NES	9/1/22
B	LOA WAS 83. SHORTENED TO MATCH 139-978. DIM 16 WAS 18.	KAT	7/5/17
A	ISSUED		

UNLESS OTHERWISE SPECIFIED INCH TOLERANCES X.....±.1 XX.....±.02 XXX.....±.005 FRACTIONS.....±1/16 ANGLE.....±1° FINISH.....250		TITLE 50-18-60-150 ASME VESSEL		DRAWN JGL		CHECKED JEJ		DRAWING NO 139-656		REV C	
MODEL: MEL 1250		CUST DWG NO NONE		TYPE ASME		DATE 8/4/2016		DATE 8/25/2016		SIZE: C	
THIRD ANGLE PROJ		SHEET 1 OF 1		 nano PURIFICATION SOLUTIONS							