

KEY FEATURES			
NUMBER	DESCRIPTION	NUMBER	DESCRIPTION
1	COMPRESSED AIR INLET	10	HMI GENERATOR INTERFACE/DISPLAY
2	NITROGEN TO BUFFER/MIXING VESSEL	11	IEC MAINS POWER SOCKET
3	NITROGEN FROM BUFFER/MIXING VESSEL	12	RJ45 (MODBUS TCP)
4	NITROGEN OUTLET TO PROCESS	13	REMOTE STOP/START - CUSTOMER FIT OPTION (M16 CABLE-GLAND KNOCK-OUT)
5	MASS FLOW CONTROLLER (IF FITTED) ADJUSTMENT ACCESS	14	USB TYPE A - CUSTOMER FIT OPTION (KNOCK-OUT PROVIDED)
6	COMPRESSED AIR INLET PRESSURE GAUGE	15	EXTERNAL FLOW METER CONNECTION (M16 CABLE-GLAND KNOCK-OUT)
7	COLUMN 'A' PRESSURE GAUGE	16	PURGE CONTROL VALVES
8	COLUMN 'B' PRESSURE GAUGE	17	NRV ACCESS PLATES
9	NITROGEN OUTLET TO PROCESS PRESSURE GAUGE	18	MOUNT SLOTS (X4)

VARIABLE WEIGHTS & DIMENSIONS						
MODEL	PRODUCT HEIGHT	TO BUFFER	COG 1	COG 2	COG 3	APPROX. WEIGHT
	A	B	C	D	E	F
GEN ₂ MINI i4.0 060	738mm [29IN]	681mm [26.8IN]	222mm [8.8IN]	391mm [15.4IN]	191mm [7.5IN]	57KG [126LBS]
GEN ₂ MINI i4.0 080	918mm [36.1IN]	861mm [33.9IN]	222mm [8.8IN]	458mm [18IN]	184mm [7.2IN]	66KG [146LBS]

CONNECTION			
NUMBER	DESCRIPTION	SIZE & TYPE	
1	COMPRESSED AIR INLET	1/2" BSP	1/2" NPT
2	NITROGEN TO BUFFER/MIXING VESSEL	1/2" BSP	1/2" NPT
3	NITROGEN FROM BUFFER/MIXING VESSEL	1/4" BSP*	
4	NITROGEN OUTLET TO PROCESS	1/2" BSP*	

* GENERATOR AVAILABLE WITH NPT ADAPTORS FITTED AT THESE CONNECTION POINTS

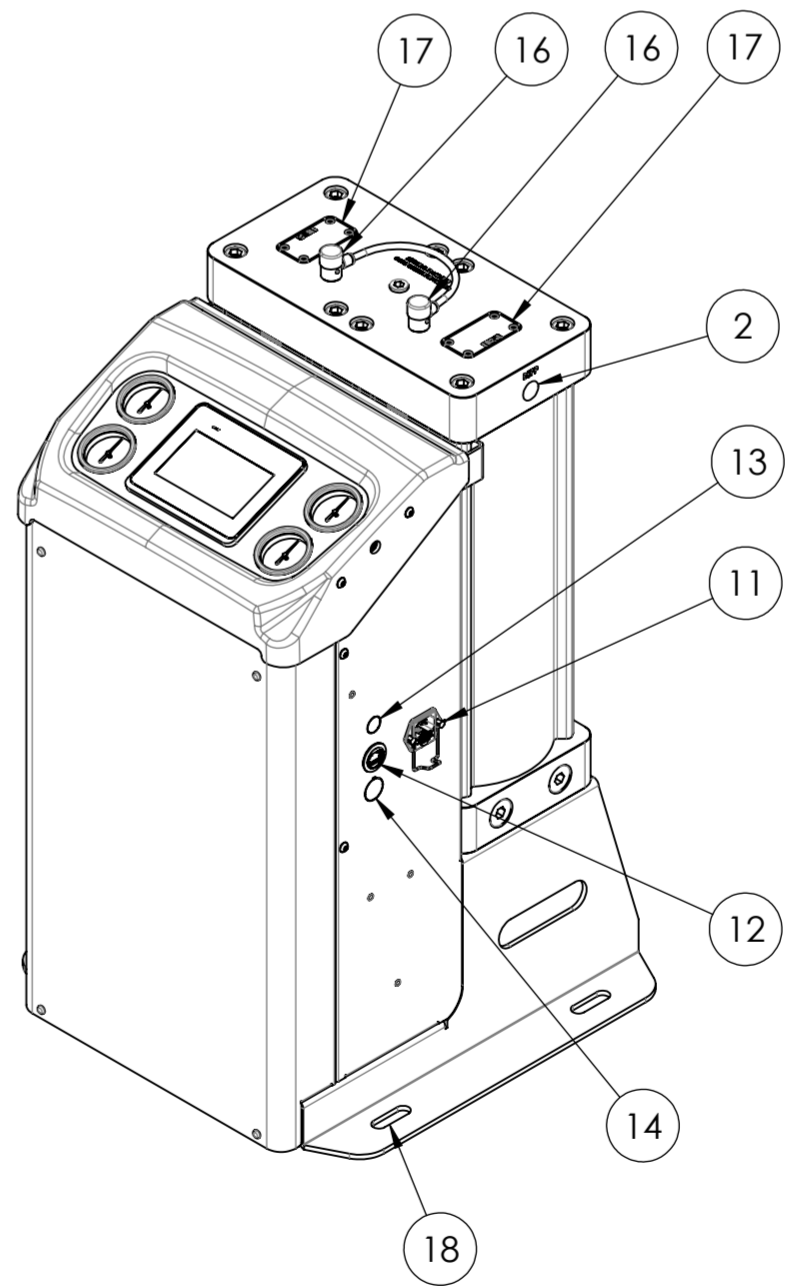
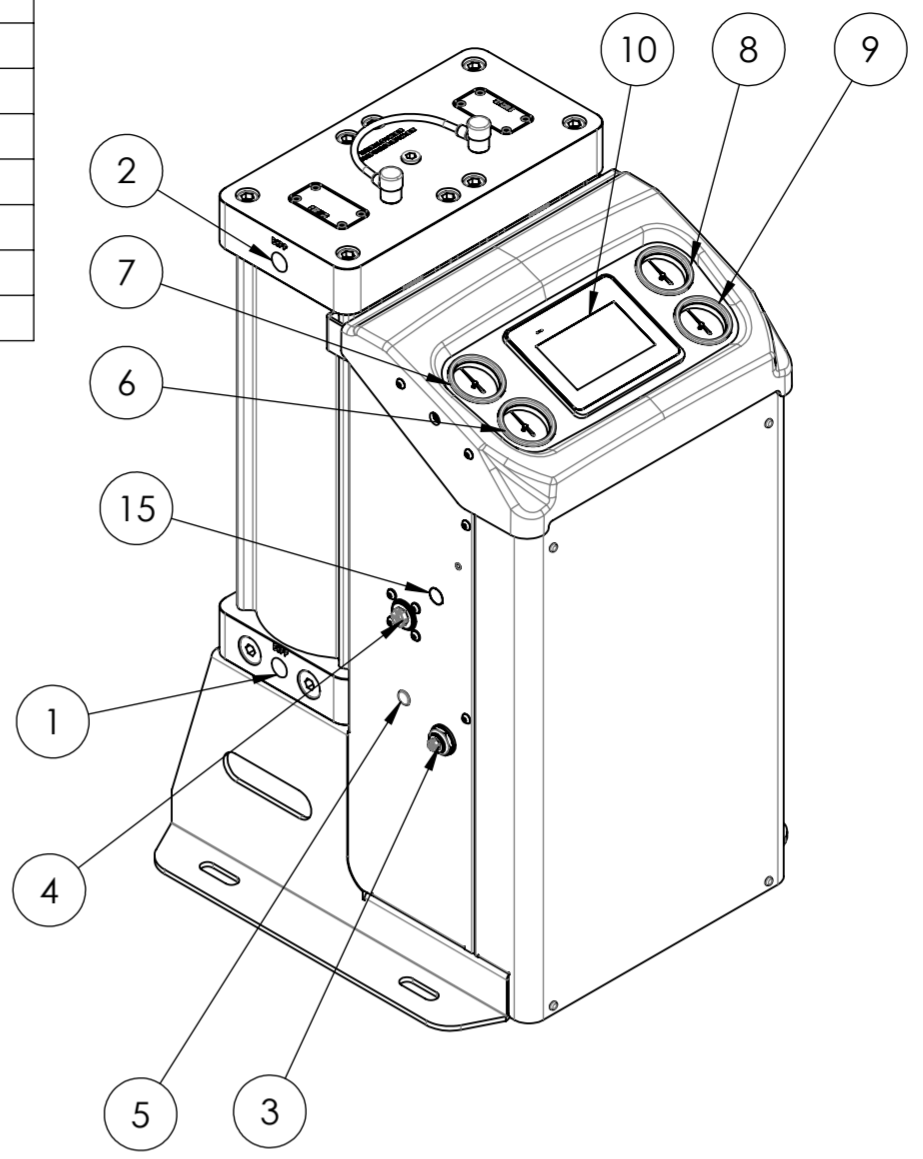
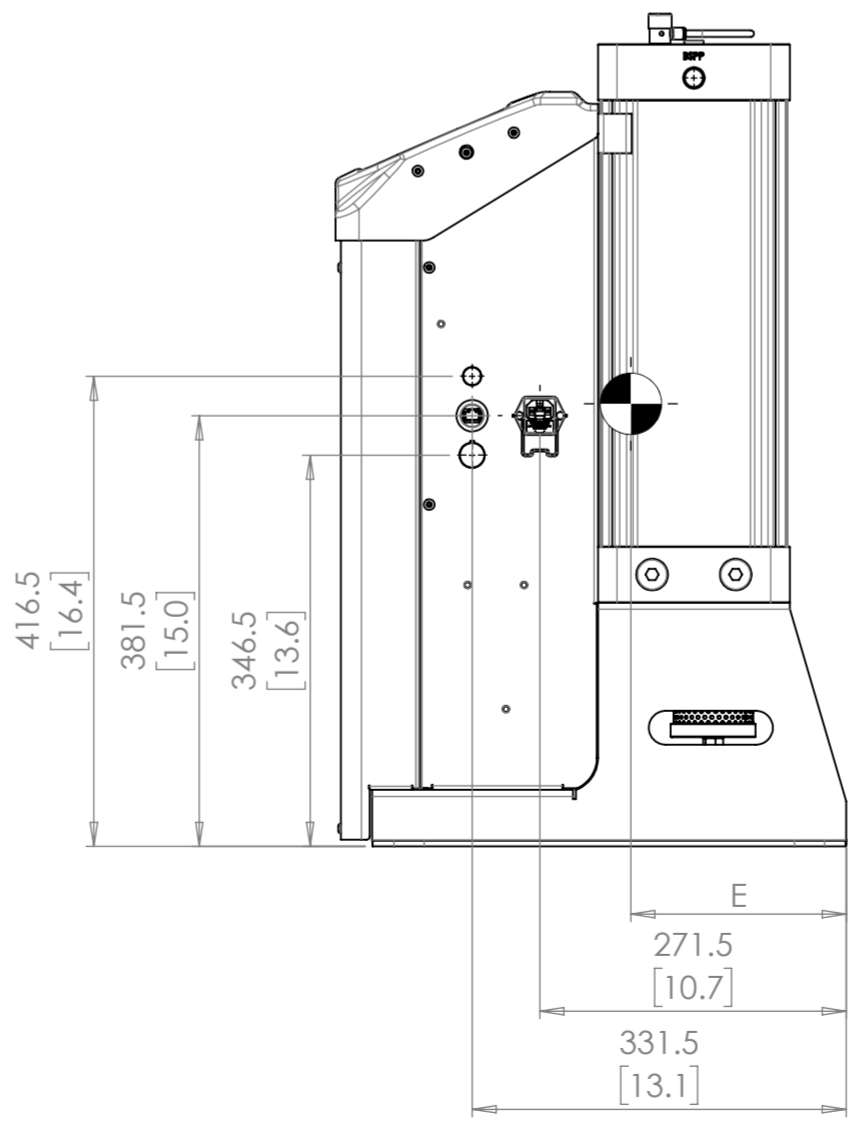
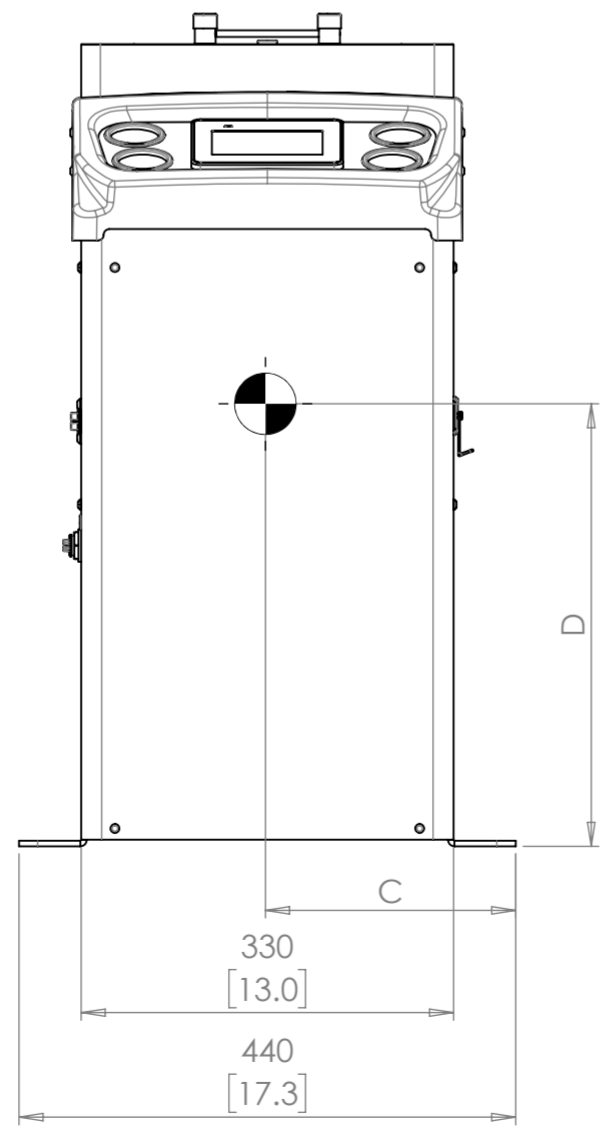
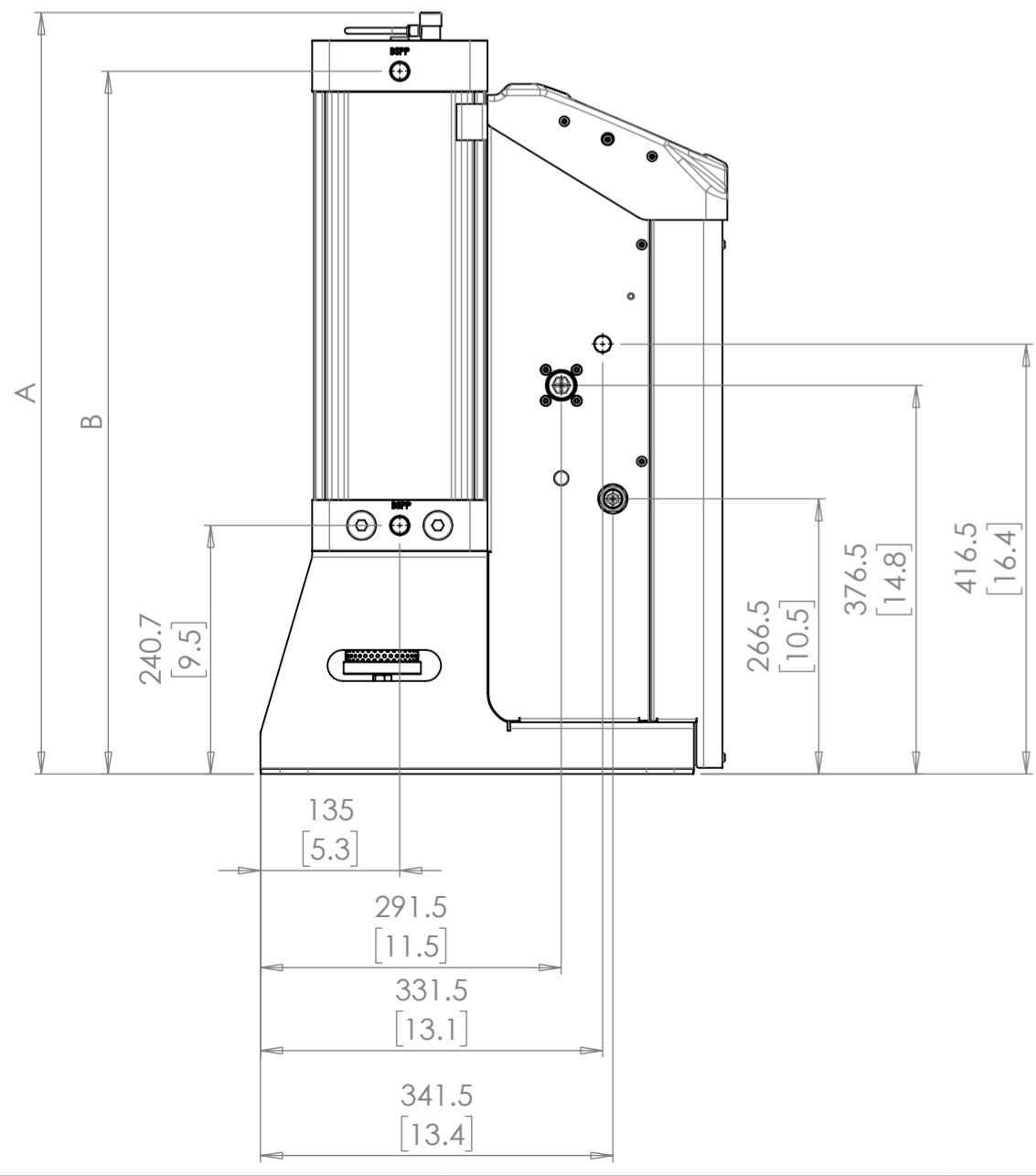
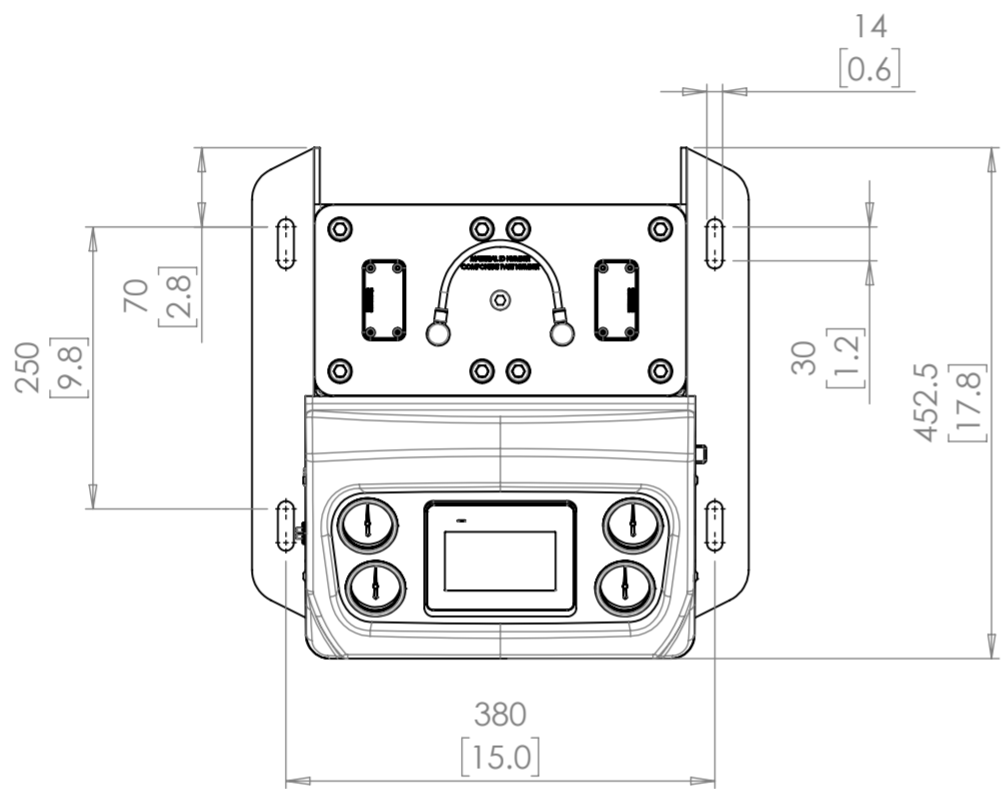

REVISIONS			
REV.	DESCRIPTION	DATE	APPROVED
01	RELEASE TO SALES	01/11/23	ME
02	NPT ADAPTORS ADDED - AIR QUALITY SPEC MOD	05/01/24	IC

NOTES:
PRODUCT SPECIFICATION

MINIMUM INLET AIR QUALITY:
 ISO 8573: 2010 CLASS 1.4.1
 (1.2.1 WITH HIGH OIL VAPOUR CONTENT)

MINIMUM WORKING PRESSURE:
 6 BARG [87 PSIG]

MAXIMUM WORKING PRESSURE:
 10 BARG [145 PSIG]

MINIMUM INLET TEMPERATURE:
 5°C [41°F]

MAXIMUM INLET TEMPERATURE:
 50°C [122°F]

RECOMMENDED OPERATING TEMPERATURE:
 20...25°C [68...77°F]

SUPPLY VOLTAGE:
 100 - 240V AC @ 50/60Hz

FUSE RATING:
 3A

POWER CONSUMPTION:
 72W

O2 ANALYSER OPTIONS:
 ZC - [% PURITY] 0.5 - 5.0%
 ZP - [PPM PURITY] 10PPM - 1000PPM
 OFFSPEC GAS FLUSH VALVE INCLUDED WITH ANALYSERS

DEWPOINT MONITORING OPTIONS:
 INLET DEWPOINT -50/+50°C DP [-58/+122°F DP]
 OUTLET DEWPOINT -100/+20°C DP [-148/+68°F DP]

GENERAL TOLERANCES UNLESS OTHERWISE STATED:
 X ± 0.5mm | X.X ± 0.25mm | X.XX ± 0.1mm
 ANGLES ± 0.5°

	DRAWN	CHECKED	APPROVED
NAME	AH	IC	ME
DATE	30-10-23	01-11-23	01-11-23

nano-purification solutions limited
www.nano-purification.com

© NANO-PURIFICATION SOLUTIONS LTD 30/10/2023
 THE ORIGINAL OF THIS DRAWING IS COPYRIGHT AND CONTAINS CONFIDENTIAL INFORMATION. IT IS THE PROPERTY OF NANO-PURIFICATION SOLUTIONS LTD WITHOUT WHOSE PERMISSION IT MAY NOT BE COPIED, SHOWN OR HANDLED TO A THIRD PARTY OR OTHERWISE USED AND IT IS TO BE RETURNED PROMPTLY UPON REQUEST TO NANO-PURIFICATION SOLUTIONS LTD.

MATERIAL:	AS PER BOM	WEIGHT (KG):	TABLE 'F'
FINISH:	N/A		
TITLE:	GEN2 MINI i4.0 (HMI PREMIUM)		
DWG NO.	PD-0121	REVISION:	02
SCALE	1:6.7	SHEET	1 of 2
DO NOT SCALE DRAWING		SHEET SIZE	A2

KEY FEATURES			
NUMBER	DESCRIPTION	NUMBER	DESCRIPTION
1	COMPRESSED AIR INLET	10	HMI GENERATOR INTERFACE/DISPLAY
2	NITROGEN TO BUFFER/MIXING VESSEL	11	IEC MAINS POWER SOCKET
3	NITROGEN FROM BUFFER/MIXING VESSEL	12	RJ45 (MODBUS TCP)
4	NITROGEN OUTLET TO PROCESS	13	REMOTE STOP/START - CUSTOMER FIT OPTION (M16 CABLE-GLAND KNOCK-OUT)
5	MASS FLOW CONTROLLER (IF FITTED) ADJUSTMENT ACCESS	14	USB TYPE A - CUSTOMER FIT OPTION (KNOCK-OUT PROVIDED)
6	COMPRESSED AIR INLET PRESSURE GAUGE	15	EXTERNAL FLOW METER CONNECTION (M16 CABLE-GLAND KNOCK-OUT)
7	COLUMN 'A' PRESSURE GAUGE	16	PURGE CONTROL VALVES
8	COLUMN 'B' PRESSURE GAUGE	17	NRV ACCESS PLATES
9	NITROGEN OUTLET TO PROCESS PRESSURE GAUGE	18	MOUNT SLOTS (X4)

VARIABLE WEIGHTS & DIMENSIONS						
MODEL	PRODUCT HEIGHT	TO BUFFER	COG 1	COG 2	COG 3	APPROX. WEIGHT
	A	B	C	D	E	F
GEN ₂ MINI i4.0 100	1093mm [43IN]	1036mm [40.8IN]	222mm [8.8IN]	569mm [22.4IN]	188mm [7.4IN]	80KG [177LBS]
GEN ₂ MINI i4.0 110	1243mm [48.9IN]	1186mm [46.7IN]	222mm [8.8IN]	625mm [24.6IN]	183mm [7.2IN]	88KG [194LBS]
GEN ₂ MINI i4.0 120	1493mm [58.8IN]	1436mm [56.5IN]	222mm [8.8IN]	724mm [28.5IN]	177mm [7IN]	100KG [220LBS]
GEN ₂ MINI i4.0 130	1843mm [72.6IN]	1786mm [70.3IN]	222mm [8.8IN]	872mm [34.3IN]	171mm [6.7IN]	117KG [258LBS]

CONNECTION			
NUMBER	DESCRIPTION	SIZE & TYPE	
1	COMPRESSED AIR INLET	1/2" BSP	1/2" NPT
2	NITROGEN TO BUFFER/MIXING VESSEL	1/2" BSP	1/2" NPT
3	NITROGEN FROM BUFFER/MIXING VESSEL	1/4" BSP*	
4	NITROGEN OUTLET TO PROCESS	1/2" BSP*	

* GENERATOR AVAILABLE WITH NPT ADAPTORS FITTED AT THESE CONNECTION POINTS

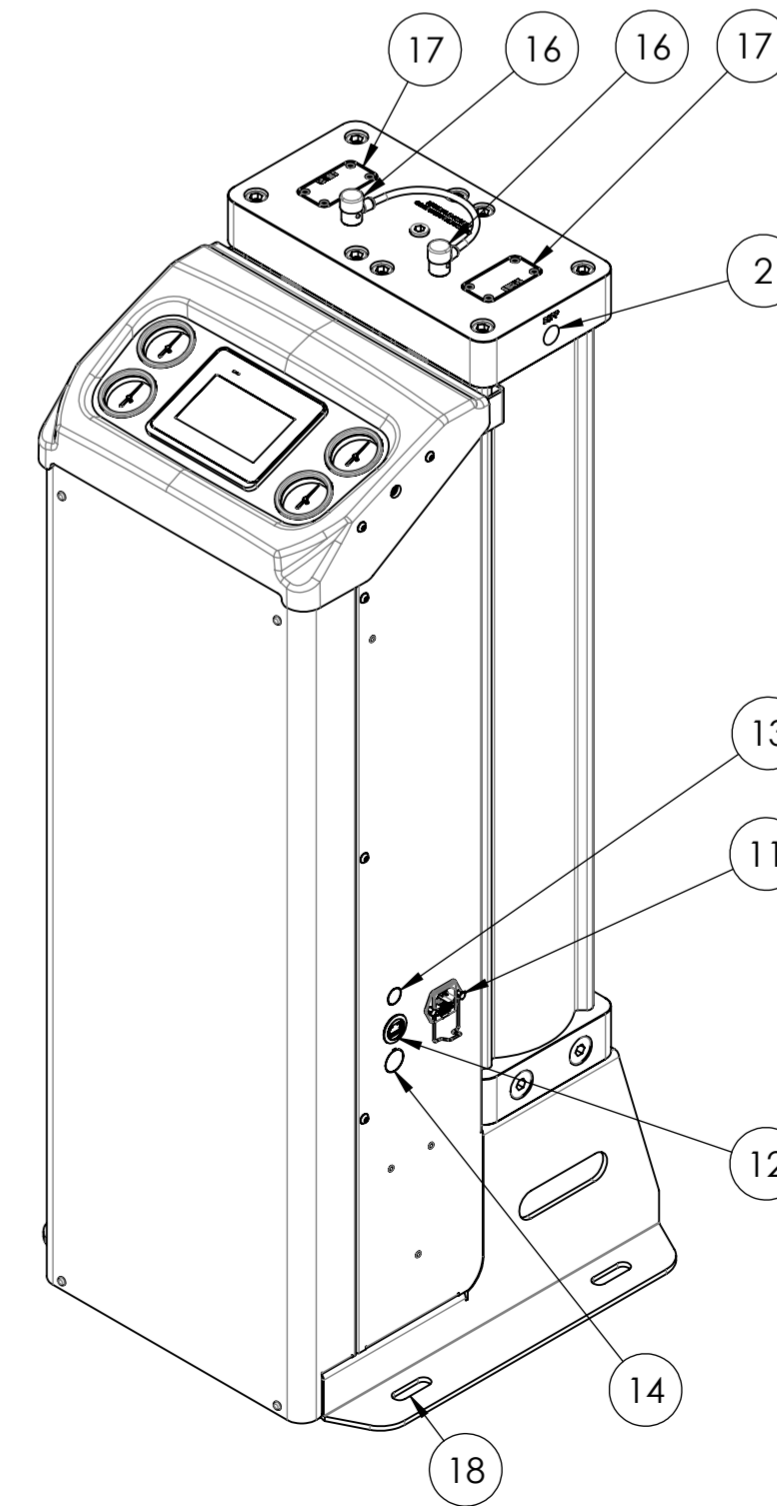
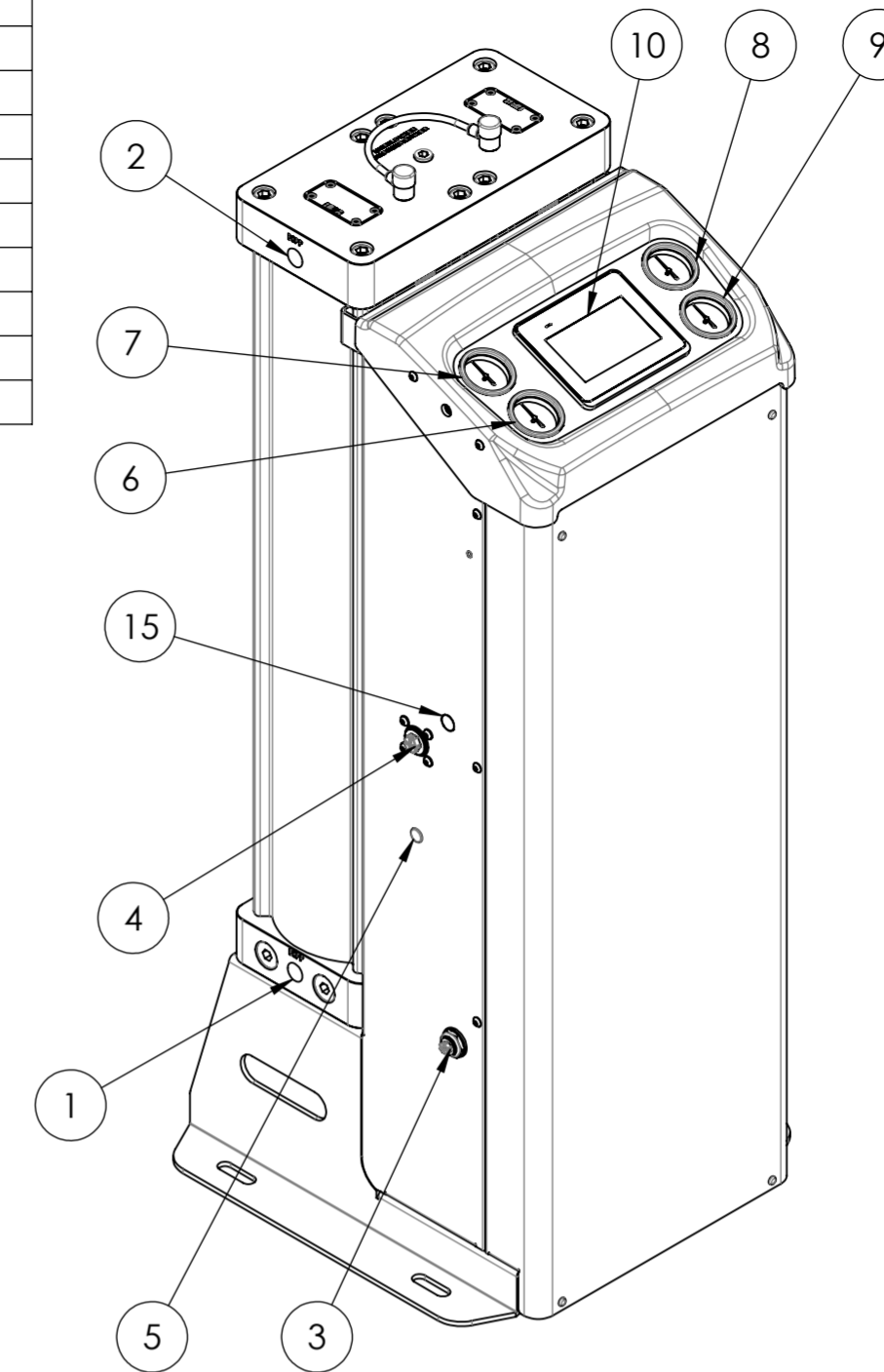
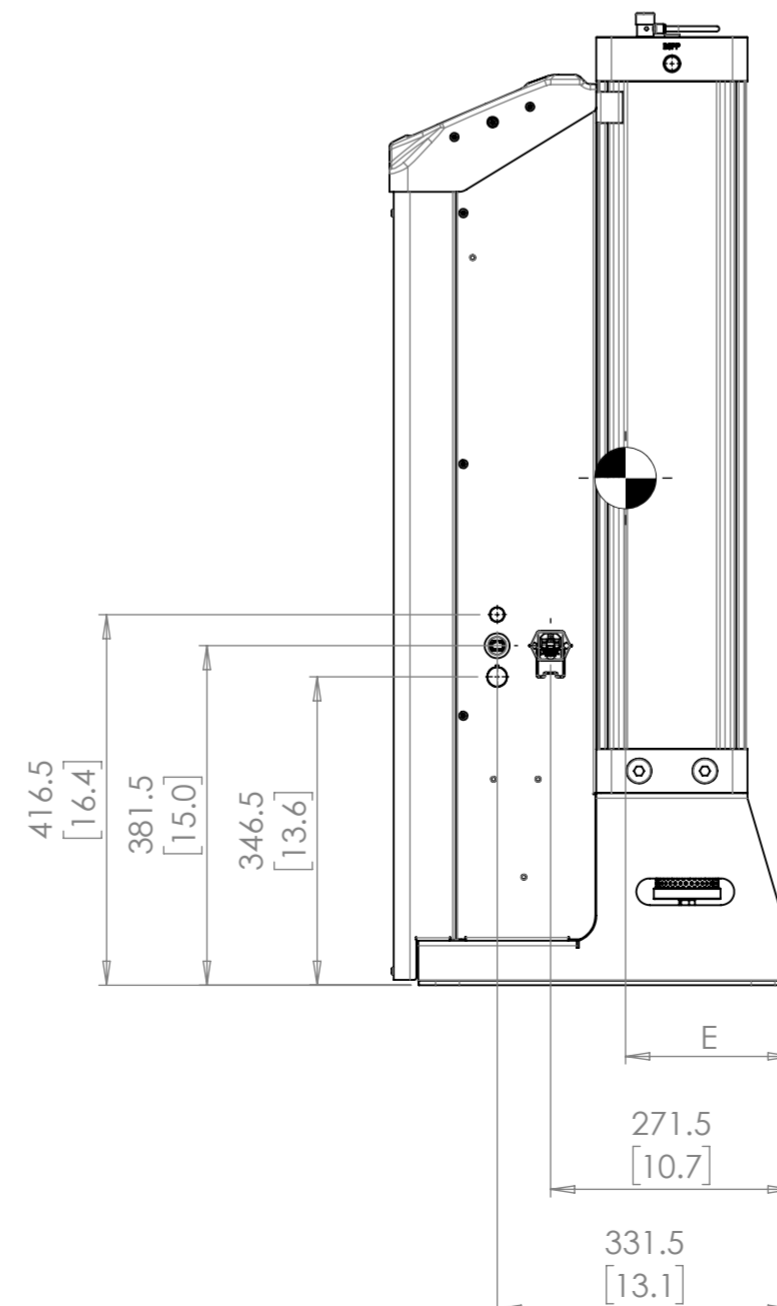
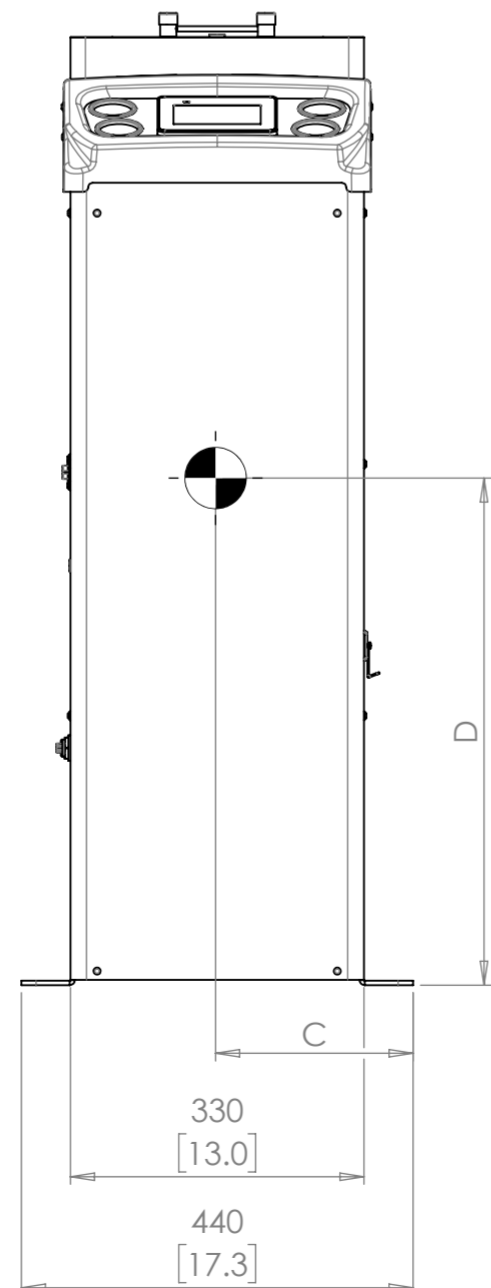
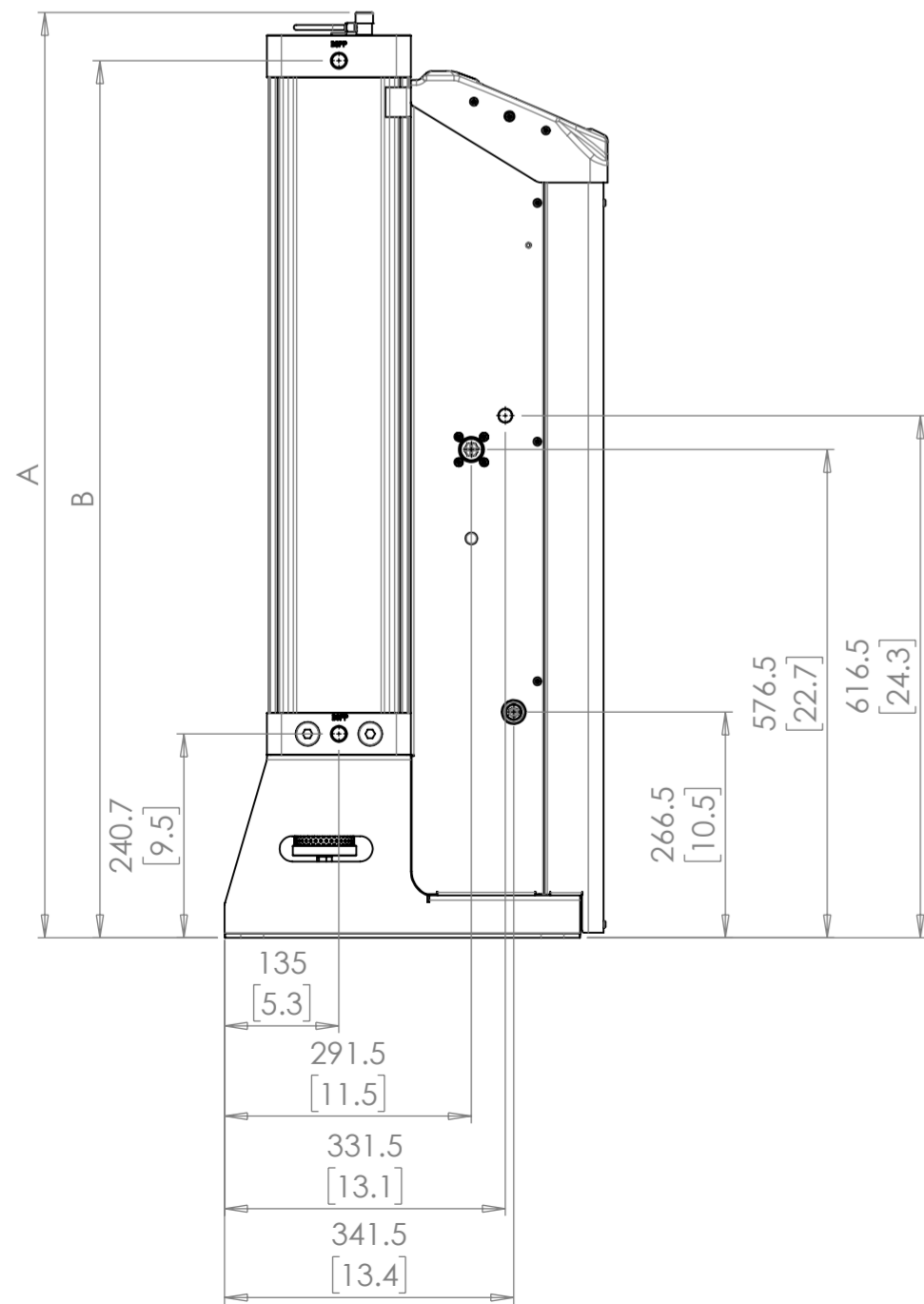
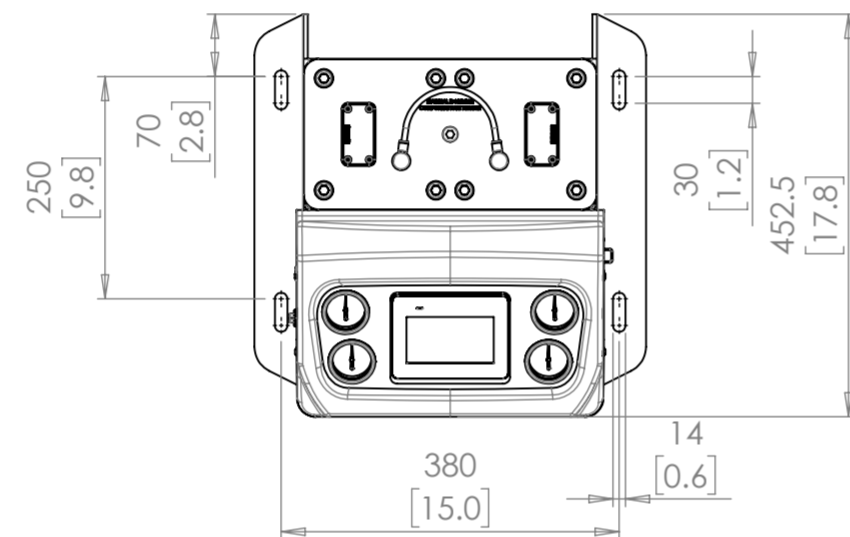

REVISIONS			
REV.	DESCRIPTION	DATE	APPROVED
01	RELEASE TO SALES	01/11/23	ME
02	NPT ADAPTORS ADDED - AIR QUALITY SPEC MOD	05/01/24	IC

NOTES:
PRODUCT SPECIFICATION

MINIMUM INLET AIR QUALITY:
 ISO 8573: 2010 CLASS 1.4.1
 (1.2.1 WITH HIGH OIL VAPOUR CONTENT)

MINIMUM WORKING PRESSURE:
 6 BARG [87 PSIG]

MAXIMUM WORKING PRESSURE:
 10 BARG [145 PSIG]

MINIMUM INLET TEMPERATURE:
 5°C [41°F]

MAXIMUM INLET TEMPERATURE:
 50°C [122°F]

RECOMMENDED OPERATING TEMPERATURE:
 20...25°C [68...77°F]

SUPPLY VOLTAGE:
 100 - 240V AC @ 50/60Hz

FUSE RATING:
 3A

POWER CONSUMPTION:
 72W

O2 ANALYSER OPTIONS:
 ZC - [% PURITY] 0.5 - 5.0%
 ZP - [PPM PURITY] 10PPM - 1000 PPM
 OFFSPEC GAS FLUSH VALVE INCLUDED WITH ANALYSERS

DEWPOINT MONITORING OPTIONS:
 INLET DEWPOINT -50/+50°C DP [-58/+122°F DP]
 OUTLET DEWPOINT -100/+20°C DP [-148/+68°F DP]

GENERAL TOLERANCES UNLESS OTHERWISE STATED:
 X ± 0.5mm | X.X ± 0.25mm | X.XX ± 0.1mm
 ANGLES ± 0.5°

	DRAWN	CHECKED	APPROVED
NAME	AH	IC	ME
DATE	30-10-23	01-11-23	01-11-23

nano-purification solutions limited
www.nano-purification.com

© NANO-PURIFICATION SOLUTIONS LTD 30/10/2023
 THE ORIGINAL OF THIS DRAWING IS COPYRIGHTED AND CONTAINS CONFIDENTIAL INFORMATION. IT IS THE PROPERTY OF NANO-PURIFICATION SOLUTIONS LTD WITHOUT WHOSE PERMISSION IT MAY NOT BE COPIED, SHOWN OR HANDLED TO A THIRD PARTY OR OTHERWISE USED AND IT IS TO BE RETURNED PROMPTLY UPON REQUEST TO NANO-PURIFICATION SOLUTIONS LTD.

MATERIAL:	AS PER BOM	WEIGHT (KG):	TABLE 'F'
FINISH:	N/A		
TITLE:	GEN2 MINI i4.0 (HMI PREMIUM)		
DWG NO.	PD-0121	REVISION:	02
SCALE	1:8.5	SHEET	2 of 2
DO NOT SCALE DRAWING		SHEET SIZE	A2