

NOTES:  
1. UNLESS OTHERWISE SPECIFIED DIMENSIONS ARE IN MM

Work Pressure (psi) (Max)	250
Test Pressure (psi) (Max)	190
Paint	BLACK
Customer Part No:	X-CC600-3
Fin System	7318/7101

UNLESS OTHERWISE SPECIFIED ALL DIMENSIONS ARE REFERENCE



THE INFORMATION HEREON IS THE PROPERTY OF NANO-PURIFICATION SOLUTIONS. ANY COPYING OR TRANSMITTAL WITHOUT PERMISSION FROM NANO-PURIFICATION SOLUTIONS IS PROHIBITED

DRWN BY:	Nance
DATE:	4/16/09
ENGR:	Nance

TITLE	
Aftercooler Assembly	
DWG. NO.	3703.398.0000
PAGE:	1 of 2
REV.	-

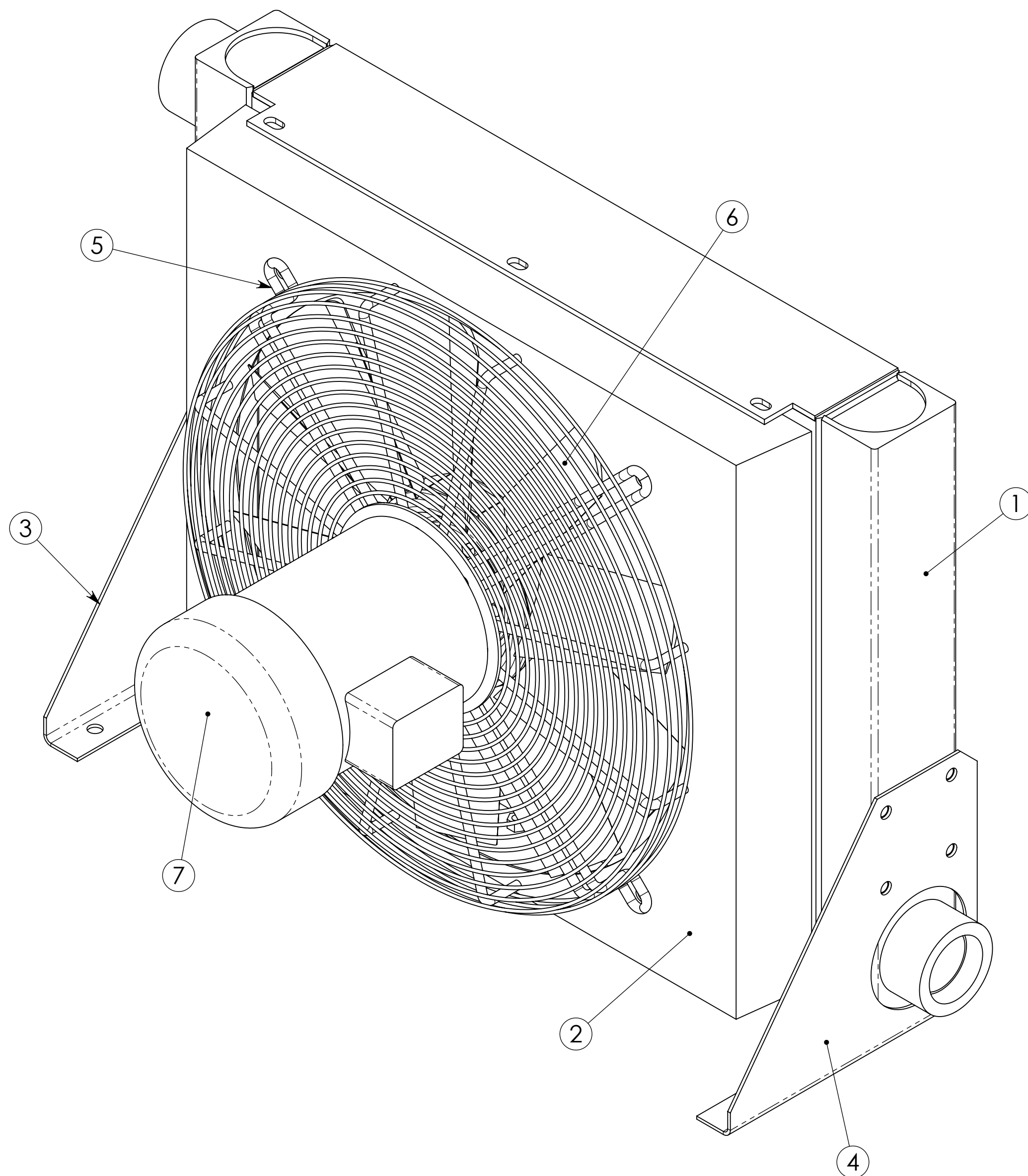

ITEM NO.	QTY.	PART NUMBER	DESCRIPTION
7	1	8407.112.4103	Leeson Motor 1HP;56C;3PH;1740RPM TEFC
6	1	8400.132.0020	Fan 19.7-10-3L-PPG-30B 5/8" x 3/16", 5/32"
5	1	1872.013.4030	20" Fan Guard
4	1	3703.018.0001	Mounting Bracket (Right)
3	1	3703.018.0002	Mounting Bracket (left)
2	1	1872.383.4010	Shroud Assembly
1	1	3703.029.4000	X-CC600-C Cooler

Work Pressure (psi) (Max)	250
Test Pressure (psi) (Max)	190
Paint	BLACK
Customer Part No:	X-CC600-3
Fin System	7318/7101

UNLESS OTHERWISE SPECIFIED  
ALL DIMENSIONS ARE REFERENCE

**nano**  
www.nano-purification.com

THE INFORMATION HEREON IS THE PROPERTY OF NANO-PURIFICATION SOLUTIONS. ANY COPYING OR TRANSMITTAL WITHOUT PERMISSION FROM NANO-PURIFICATION SOLUTIONS IS PROHIBITED

DRWN BY: Nance  
DATE: 4/16/09  
ENGR: Nance

TITLE  
**Aftercooler Assembly**  
DWG. NO. 3703.398.0000  
PAGE: 2 of 2  
REV. -