

NPTD12115B Series Drain

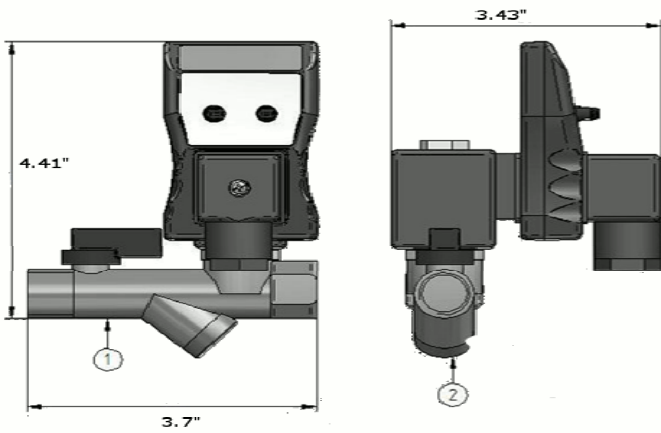

INSTALLATION

- Verify flow direction. (stamped on valve body)
- Valve can be mounted in any position.
- Install a condensate drain on the outlet side of drain valve for proper collection and drainage of condensate.
- If tubing is used for draining, Beware of "Whipping" when valve is open.
- Remove Contact Block from connector and attach wires as shown at right.

SPECIFICATIONS

TIMER

Interval time (T2)	.5 - 45 minutes
Discharge time (T1)	.5 - 10 seconds
Supply Voltage	12v-240v 50/60Hz (+/- 10%)
Current Consumption	4mA Max.
Operating Temperature	-10°C to +50°C
Environmental Protection	NEMA 4
Case Material	ABS Plastic FR Grade
Connection	DIN 43650A ISO 4400/6952

Type	2-way direct acting valve
In/Out Ports	1/2"NPT X 1/2"NPT Male Inlet
Max. Working Pressure	300 PSI
Operating Temperature	35°F - 130°F Ambient
Media Temperature	190°F Max.
Valve Body	Forged Brass I
Orifice	5/32" - 4.0MM
Insulation	Thermal Group H
Environmental Protection	IP 65/Nema 4
Supply Voltage	12v - 240v (see coil for correct supply)
Voltage Tolerance	+/- 10%
Mounting	Any position

WHEN INSTALLING THE ELECTRONIC DRAIN VALVE MAKE SURE:

- POWER IS TURNED OFF
- AIR SYSTEM IS DRAINED (ZERO PRESSURE)

CONTACT BLOCK

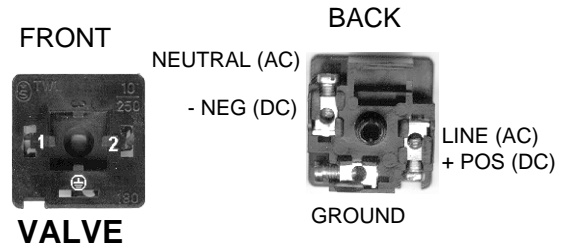

MAINTENANCE

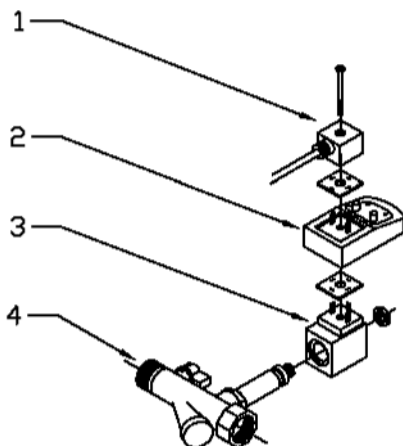

REPLACEMENT PARTS

Description	Part No.
1 - Electric Cord	3021457F0000
(6 foot Length Molded Din)	
1- Din Connector	C18209N2
1- Conduit Connector	M550Z-RB
2 - Timer	8601 (24v-240v) 8671 (10v-30v)
3 - Coil	
Standard	
24v AC	42460
48v AC	295210
115v AC	42320
230v AC	42300
12v DC	297500
24v DC	42480
4- Valve Only	321490
Valve Assy. (Valve & Coil)	
1/2"-115V	321492
1/2"-230V	321493

TIMER SETTING

- Set Interval time (T2) using Right adjusting knob.
- Set DISCHARGE time(T1) using LEFT adjusting knob.
- Set T1 to 2 seconds and T2 to 20 minutes.
- (Adjust as necessary)
- The Combo **has a built in strainer.**
- We recommend periodically checking to ensure strainer has not clogged.
- Testing the drain is accomplished by pressing on the Test area of the timer.